

Power DogTM

QUICK SPLIT 24/29 Rental

OWNER'S MANUAL

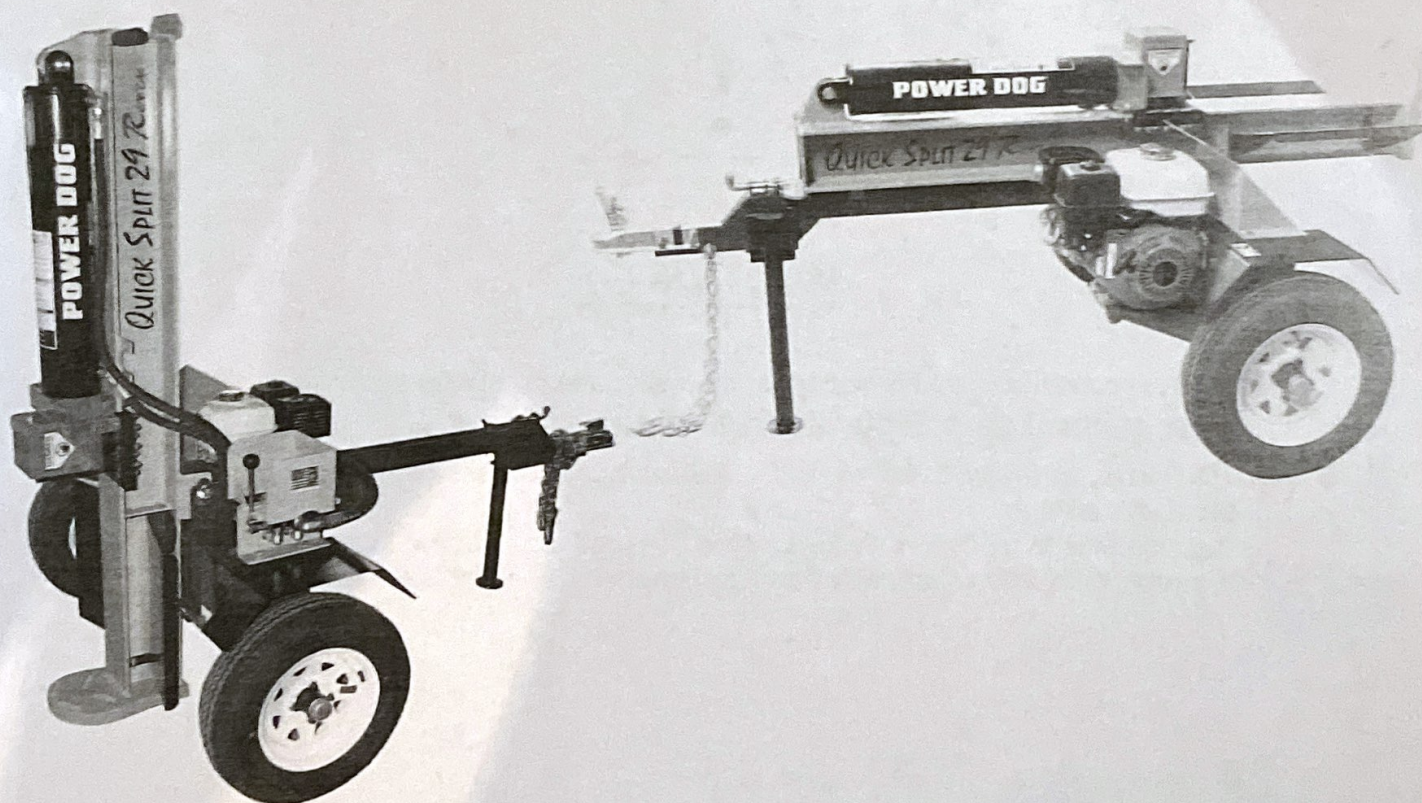

KUHNS POWER EQUIPMENT, LLC

10101 Shively Road, (C.R. 46) - Nappanee, IN 46550

Ph. 574-862-4592 / 1-866-505-8085

Warnings

WARNING!

WARNING to purchasers of internal combustion engine equipped machinery or devices in the **State of California**:

The equipment you have purchased does not have a spark arrestor muffler. If this equipment is to be used on any forest and brush covered land or grass covered un-improved land in the state of California, the law requires that a spark arrestor muffler be installed and be in effective working order. The spark arrestor muffler must be attached to the exhaust system, and comply with Section 4442 of the California Public Resources Code.

The engine exhaust from this equipment contains chemicals known to the State of California to cause cancer, birth defects or other reproductive harm.



WARNING!

This manual contains vital information for the safe use and efficient operation of this equipment. **Carefully read this Operation & Maintenance Manual before using this equipment**, as failure to adhere to the instructions could result in death, serious bodily injury and/or property damage.

This log splitter is to be used only for splitting firewood logs. Using this machine for any other purpose may cause injury and or property damage. Improper use of this log splitter will void the warranty.

HORIZONTAL / VERTICAL 24 / 29 TON LOG SPLITTER

Table of Contents

Warnings	Page 2
Table of Contents	Page 3
Assembly	Page 4
Do	Page 5
Do Not	Page 6
General Description	Page 7
Specifications	Page 7
Log Splitter Preparation	Page 7
General Safety Information	Page 8
Training	Page 8
Preparation	Page 8
Operation	Page 9
Maintenance	Page 10
Periodic Maintenance Schedule	Page 10
Fueling	Page 11
Transportation	Page 11
Lubrication	Page 11
Oil and Fuel	Page 11
Controls	Page 11-12
Storage	Page 12
Maintenance Record	Page 13
Troubleshooting Points	Page 13
Parts Breakdown	Page 14-17
Warranty	Page 18

Assembly

Caution: Do not attempt to assemble this unit by yourself



STEP 1 - Remove tires, fenders, hardware package, hitch and coupler from skid.

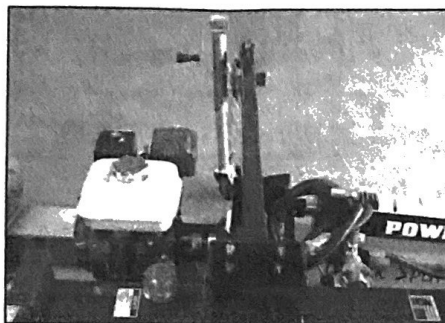

STEP 2 - Fasten hitch to main tank with 4 - 1/2 x 1 1/2 bolts

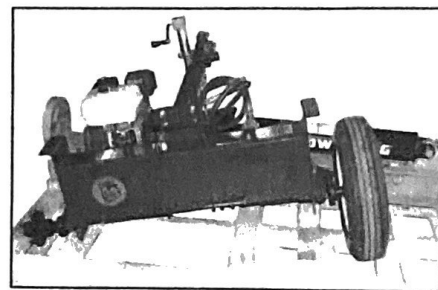

STEP 3 - Lift on end of tank and install wheel. Repeat on other side.

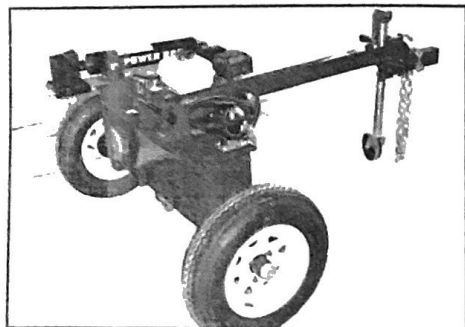

STEP 4 - Roll tank and hitch assembly off of skid, turn jack stand to down position

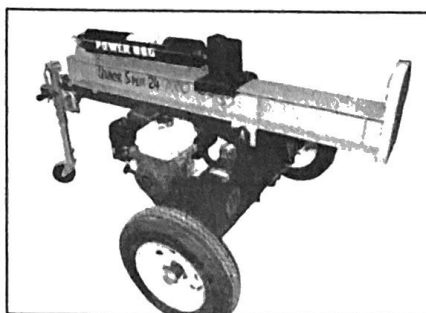

STEP 5 - Remove pivot pin from tank; lift main beam onto tank and secure with pin

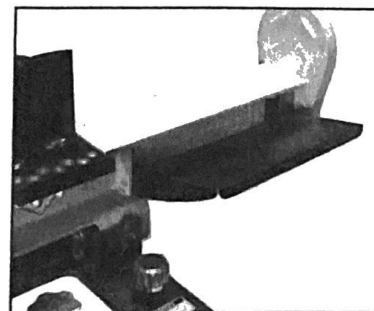

STEP 6 - Install log trays with 8 - 3/8 x 3/4 bolts

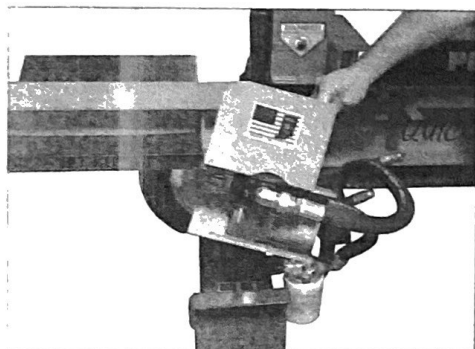

STEP 7 - Remove valve

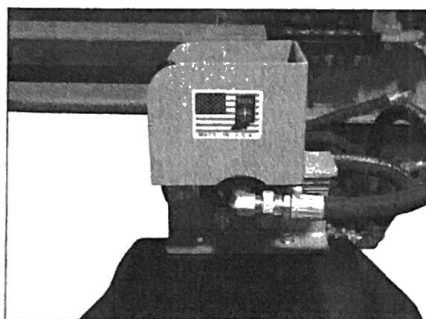

STEP 8 - Position fender and re-install valve bracket. Note: fender notch should be in back

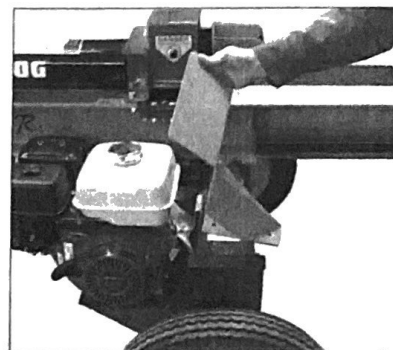

STEP 9 - Remove engine guard

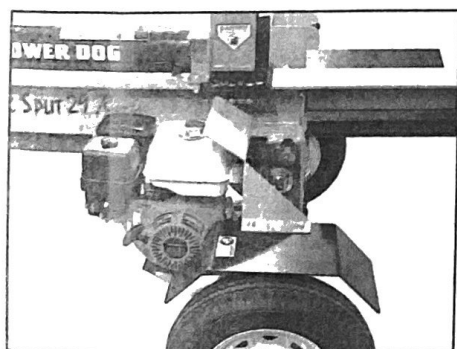

STEP 10 - Position fender and re-install engine guard. NOTE: fender notch should be in front.



STEP 11 - Attach hoses to cylinder

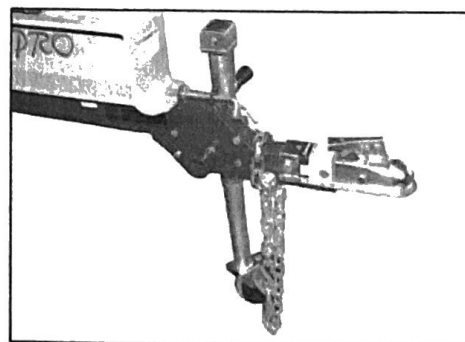

STEP 12 - Fasten hitch coupler with 2 - 1/2 x 3 bolts

WARNING: This unit ships with no oil in reservoir or engine!
IMPORTANT: Set RPM at 3200 before operating

Owner / Operator's Responsibility

It is the owner / operator's responsibility to:

1. Carefully read and understand the entire Operation & Maintenance Manual along with the assembly instructions.
2. Be certain that all assembly procedures are followed as described in the following instructions.
3. Fill the equipment with the proper fluids before starting as described in the Operation & Maintenance Manual and the engine manufacturer's manual.
4. Operate the log splitter according to safe operating procedures as spelled out in the Operation & Maintenance Manual and these assembly instructions.
5. Perform all required maintenance as directed in the Operation & Maintenance Manual, the engine manufacturer's manual, and these assembly instructions.

Assembly:

This unit must be assembled before use. Care must be taken in assembly to insure the proper functioning of the unit. Assembly must be completed in a dry and clean environment.

Do not operate this log splitter until you have read and understand the operating and safety instructions. Failure to read and follow operating instructions can result in serious injury or death to yourself and/or others.

DO

- Do make sure that anyone who operates this splitter reads and understands all operating instructions as to its proper use and operation as well as all safety instructions.
- Do keep your work area clean. Don't leave wood lying around that you could stumble over.
- Do keep hands and feet clear of splitter blade and out of splitter area while unit is in operation.
- Do wipe up spilled gasoline right away from the engine and log splitter before starting the splitter.
- Do check engine oil level and hydraulic oil level before starting the splitter.
- Do use the splitter only to split firewood logs. Use of the splitter for any other purpose is dangerous and will void the warranty.
- Do wear eye protection and protective clothing including safety shoes at all times while the log splitter is in operation to avoid any hazard from flying wood.
- Do keep children and pets away from the work area while you are operating the log splitter.
- Do shut off the engine if you leave the log splitter, even for a short period of time.
- Do operate the log splitter on a level surface. Block the wheels to prevent unintended movement.
- Do let go of the control lever after it is pushed forward. The ram will return automatically at the end of the stroke. The ram can also be stopped at any point in its travel and \ returned.
- Do remove both hands from the log before activating the control lever.
- Do be sure the log splitter is kept in sound mechanical condition. Proper care, maintenance and following all operating and safety instructions will provide you with many years of trouble free and safe operation.

DO NOT



- Do not allow anyone to operate the log splitter until they have read and understand the operating and safety instructions.
- Do not allow anyone under the age of 18 to operate the log splitter.
- Do not operate the log splitter in the vicinity of or near children or pets.
- Do not wear jewelry or loose fitting clothing or clothing with drawstrings when operating the log splitter, as such jewelry or clothing may become entangled in the moving parts of the log splitter.
- Do not operate the ram control any way other than by hand.
- Do not leave the log splitter unattended with the engine running.
- Do not operate the log splitter beyond the capabilities as outlined in the owner's manual and operating instructions.
- Do not step over the log splitter when running. Walk around the log splitter to get to the other side.
- Do not straddle the log splitter with the engine running or during operation.
- Do not allow anyone to stand near the cutting wedge when you are splitting wood, because wood may fly and become hazardous.
- Do not stand on slippery, wet, muddy or icy surfaces when operating the log splitter. Operate only when operator zone is clear for safe, secure footing.
- Do not operate the log splitter inside a building or other closed in area that does not have adequate ventilation.
- Do not refuel the log splitter with the engine running or if the engine is hot, or if the operator is smoking or while the unit is near any open flame or other ignition source.
- Do not operate the log splitter if it is in need of repairs or maintenance services.
- Do not make any modification, alterations or changes to the original configuration of the log splitter. This may cause death or serious injury and will void the warranty.
- Do not load a log onto the log splitter by holding the log at both ends of the log. Do not place your hands between the cutting wedge and the log or between two pieces of wood and the frame. See operations manual for proper loading instructions.
- Do not service or repair the log splitter without removing the spark plug wire.
- Do not allow anyone except the operator within 10 feet of the log splitter during operation.
- Do not operate the log splitter with any hydraulic fluid leak. Check hydraulic hoses before operating log splitter and repair or replace as necessary.
- Do not use any chemical cleaners or high pressure wash systems or steam cleaners to clean the log splitter. Use only a mild detergent and warm water for cleaning. Any other method may void your warranty.

GENERAL DESCRIPTION

Read carefully before attempting to install, operate or service the Power Dog log splitter. Retain this information for your future reference.

Your Power Dog log splitter is American made and constructed of the best materials available to do the job. Your safety has been considered in every feature and component of your Power Dog log splitter.

The gasoline engine operates a pump, which supplies high pressure oil to the cylinder by way of the control valve and high pressure hoses. When the control valve is moved to the forward extend position, oil is allowed to flow through the hoses to the rear of the cylinder which, in turn, forces the ram to extend outward toward the wedge. When the control lever is reversed and put in the retract position, the direction of the oil flow is changed and the high pressure oil is forced into the front of the cylinder, thereby retracting the ram. A large reservoir stores and cools the hydraulic oil and incorporates a high density filter to filter out any foreign particles and, therefore greatly extends the life of your Power Dog log splitter. A safety relief valve is preset at the factory to protect the hydraulic system from excessive pressures.

LOG SPLITTER PREPARATION PROCEDURE

The following items must be accomplished and checked before machine operation.

Log splitter should be in a level position and used only out of doors, not in an enclosed area. Make sure all connections, lines and hoses are tight and not damaged before filling with fluids.

Motor oil should be placed in the engine crankcase according to the instructions in the engine manufacturer's instructional manual. Gasoline is then put into the engine fuel tank according to the engine manufacturers operating manual. Standard fueling safety procedures must be followed during refueling. DO NOT start the log splitter engine until hydraulic oil is added to the hydraulic system.

When filling the hydraulic system of the log splitter with hydraulic oil, use Power Dog AW46 high zinc hydraulic Logsplitter oil. In cold temperatures (30 degrees or colder) use an AW32 high zinc hydraulic oil. Fill the hydraulic reservoir within 1 inch from the top of the reservoir. Replace the reservoir cap.

Place the engine stop switch to the "OFF" position. Pull the engine cord over 4 or 5 times. Place the engine stop switch to the "ON" position. Pull the engine cord and start the engine. Move the control lever to the forward extend position and let the ram move 1/2 of its length. Stop the engine. Add hydraulic oil to the hydraulic reservoir to within 1 inch of the top of the reservoir.

Start the engine. Set engine rpm at 3200. Move the control lever to the forward extend position and let the ram move to the fully extended position. Reverse the control lever and let the ram move to its full reverse position. Stop the engine. Check the hydraulic oil level and add to within 1 inch from the top of the reservoir as needed. Cycle the ram forward and reverse several times until ram movement is smooth and even. Do a final hydraulic oil check. Inspect all hoses, lines and fitting for leakage. Correct any leakage before continuing usage. Your Power Dog log splitter is now ready for service!

GENERAL SAFETY INFORMATION - TRAINING

- Read and understand the Operation & Maintenance Manual and all safety instructions before attempting to use this log splitter.
- Do not allow anyone to operate your log splitter who has not read the Operation & Maintenance Manual and safety instructions or has not been instructed on the safe use of the log splitter.
- Never allow children or untrained adults to operate this log splitter.
- Never allow anyone under the influence of any substance (drugs, alcohol, etc.) to operate this log splitter.
- Most accidents occur when more than 1 person operates the log splitter at any time. If a second person is assisting in providing logs to the operator to be split, never activate the controls until the assistant is clear of the work area. Only one person must run the log splitter at a time.
- Never allow anyone to ride on the log splitter at any time.
- Extremely high fluid pressures are developed in hydraulic log splitters. Pressurized hydraulic fluid escaping through a pin hole opening can puncture skin and cause severe injury. Therefore, the following instructions should be followed at all times.
- * Do not operate the log splitter with frayed, kinked, cracked or damaged hydraulic hoses, fittings or tubing.
 - * Avoid high pressure fluid leaks. Hydraulic oil escaping from a small hole can be almost invisible but it can penetrate skin, causing serious injury. Use pieces of cardboard or wood to detect leaks, rather than using your hands.
 - * Stop the engine and relieve hydraulic system pressure before changing or adjusting fittings, hoses, tubing or other system components.
 - * Do not adjust the pressure settings of the pump or valve.
 - * Do not check for leaks with your hands. Leaks can be located by passing cardboard or wood over the suspected area of the leak. Look for discoloration. If you are injured by escaping hydraulic oil, seek medical attention immediately. Serious infection can result if proper medical care is not administered immediately.
- Your log splitter is equipped with an internal combustion engine and if it is used near any unimproved forest, brush or grass covered land, the engine exhaust must be equipped with a spark arrestor which meets all applicable local, state and federal codes. These may be purchased from the engine manufacturer. Take appropriate fire fighting equipment with you.
- The log splitter must be used only for splitting fire wood and should be split only in the direction of the grain (not across the diameter of the log)
- Keep the operator zone and adjacent area clear to ensure safe, secure footing. The operator zone is the entire area from the operator to ten feet away from the operator. No other assistant should be within this operating area when the machine is in use.

PREPARATION

- Be thoroughly familiar with all of the controls and with the proper use of the log splitter.
- Always wear safety shoes or heavy boots. (No athletic shoes)
- Always wear safety glasses or goggles with side shields and hearing protection when operating the log splitter.
- Never wear jewelry, loose clothing or clothing with strings or cords that may become entangled in moving or rotating parts of the log splitter.

GENERAL SAFETY INFORMATION (Continued)

Make sure the log splitter is on a level surface. Block the wheels securely before operating the machine to prevent unintended movement. Use chocks or split wood in front and behind each wheel to block the log splitter.

Always operate the log splitter from the indicated operator zone.

Cut all logs to be split as squarely as possible.

Handle fuel with care, it is highly flammable.

- *Use an approved fuel container designed for gasoline storage.

- *Never add fuel to a hot or running engine.

- *Fill the fuel tank outdoors with extreme care. Never indoors.

- *Replace gasoline tank cap securely and clean up all spilled fuel.

OPERATION

1. Before starting this log splitter, read and understand this entire manual including the Do Be Careful and General Safety Information. Failure to follow these rules may result in serious injury to the operator or bystanders.
2. Never leave the machine unattended with the power source operating.
3. Never operate the machine when you are under the influence of alcohol, drugs or medication.
4. The machine owner must instruct all operators in the safe operation of this log splitter.
5. Always operate the log splitter with all safety equipment in place and all controls properly adjusted for safe operation.
6. Do not run the engine at excessive speeds. Doing so increases the hazard of personal injury. Do not tamper with parts that may increase the speed recommended by the manufacturer.
7. Always keep hands and feet away from moving parts.
8. Always shut off the engine when adjusting or repairing the log splitter except as recommended by the manufacturer.
9. Do not run the engine in an enclosed area. Exhaust gas contains carbon monoxide, an odorless and deadly poisonous gas.
10. When loading the log splitter, place your hands on the sides of the log. Never place your hands or any part of your body between a log and any part of the log splitter.
11. Never attempt to split more than one (1) log at a time.
12. When the logs are not cut square, the longest portion of the log should be rotated down and placed at the cutting wedge end.
13. Use only your hand to operate the log splitter controls.
14. Operate the log splitter using only one operator. Only the operator should be within 10 feet of the machine while the log splitter is operating.
15. Read and follow all safety and warning decals installed on the machine.
16. On the vertical models, keep hands away from the cutting wedge.
17. On the vertical models, maintain balance of the beam when raising or lowering the beam.
18. On vertical models, make sure the safety pin is installed when the unit is in the vertical or splitting mode or in the horizontal towing mode.
19. Do not refuel the engine until it has cooled for several minutes.

MAINTENANCE AND STORAGE

Note: For proper maintenance, keep a written record of hour use and maintenance. Also see page 10 for further details.

Always shut off the engine. While repairing or adjusting the log splitter, except as recommended by the engine manufacturer.

Clean debris and chaff from the engine cylinder, cylinder head fins, blower housing, rotating screen and muffler areas. If the engine is equipped with a spark arrestor muffler, clean and inspect it regularly (follow engine manufacturer service instructions). Replace, if damaged.

Never store the log splitter with fuel in the tank inside a building where fumes might reach an open flame or spark. Allow the engine to cool and drain all fuel from the fuel tank before storing in any enclosed area.

Clear debris from movable parts, but only when the power source is shut off.

To prevent accidental starting, remove the spark plug wire from the spark plug and insert the terminal in the V notch in the cylinder head before working on the engine or log splitter.

Check to be sure all nuts and bolts are tight to assure the log splitter is in safe working condition.

Check engine oil level and hydraulic oil level.

Check the wear strips on the slide plate under the cutting wedge. All models equipped with wear strips should be inspected and have the wear strips replaced as needed.

PERIODIC MAINTENANCE

Check engine oil.....	daily
Check hydraulic oil.....	daily
Inspect hydraulic hoses.....	daily
Inspect & clean engine cooling fins.....	daily
Check log splitter tire pressure.....	daily
Check trailer hitch and safety chains.....	daily
Clean engine air filter.....	weekly
Check wear strips.....	monthly
Inspect for and repair damaged parts.....	daily
Inspect & gap or replace spark plug.....	annually
Replace hydraulic oil and clean filter.....	annually or as required
Check & service wheel bearings.....	monthly
Inspect all bolts & fittings and tighten as needed.....	weekly
Change engine oil as indicated in the engine manufacturer's owners manual.	

FUELING

Use properly marked and approved safety containers for gasoline storage and for refueling engine.

Refuel engine outdoors. Never refill the fuel tank indoors.

Shut off the engine and allow it to cool before refueling.

While refueling engine, do not smoke or create sparks in the same area.

Avoid spilling gasoline and clean up all spilled gasoline before starting the engine.

SAFE TRANSPORTATION OF THE LOG SPLITTER

When transporting the log splitter over the road, fuel coming from the gasoline tank should be shut off by means of the shut off valve located under the gasoline tank. Some engines do not have a gasoline shut off valve. If the engine is not equipped with a gasoline shut of valve, drain all gasoline before towing the log splitter.

LUBRICATION: OIL & FUEL

A written record should be kept to log hours of use.

Motor oil in the crankcase of the engine and fuel specifications must be flowed from the engine manufacturer's manual supplied with the log splitter.

Dexron II or III or equivalent is recommended for the hydraulic system.

After every 5 hours of operation, the log splitter should be stopped and, with the ram in a retracted position, the hydraulic oil level should be checked. It should be 1 to 2 inches from the top of the filler cap hole.

If a considerable amount of towing or over the road use is necessary, the wheel bearing should be packed with wheel bearing grease every 1000 miles or once a month as needed.

After every 50 hours of operation, the motor oil should be changed and the air filter should be checked, and changed as necessary.

After 250 hours of operation, the rubber spider between the motor shaft and hydraulic pump should be inspected for damage.

Hydraulic oil should be changed as required, but more frequently for heavy duty or commercial use the oil should be changed annually. In extremely dusty or dirty conditions the oil should be changed more frequently to meet these unusual conditions.

CONTROLS

Engine run - stop switch

To shut off the engine, turn the switch to the stop position. Before attempting to start the engine, be sure the switch is in the run position. Not all engines have this control on them.

Engine choke control

If the engine does not start initially, set the choke control to full on position. When the engine starts, se the choke control to the normal operating position.

CONTROLS (Continued)

Engine recoil starter handle

It takes short, steady pulls in rapid succession to start the engine. Do not jerk the starter handle. Do not release the starter handle when fully extended and let it snap back.

Ram control valve

To extend the ram, push the control lever to extend as the decal on the valve indicates. Holding the lever in this position, the ram will continue to travel forward to its fully extended position until either the control lever is released or until the ram reaches its fully extended position.

As a safety precaution, when the control lever is released it will automatically move to the center hold position, and the ram will stop. This control lever feature is referred to as a "dead man" control switch. To move the ram, push the control lever in the same direction as wish the ram to move.

IDENTIFICATION

Additional or replacement manuals may be obtained from Kuhns Power Equipment, LLC. When the log splitter has been received, complete the following record:

Model: _____

Date of purchase: _____

Where purchased: _____

Always mention the log splitter model number when ordering or inquiring about parts or service.

For convenience in ordering, parts are listed by part number, description and quantity. If in doubt as to what part is needed, send a full description, sketch or the part itself with the order. Prior arrangements must be made before returning a unit or part for warranty service.

STORAGE

For Safe Storage

Clean dirt and debris from the engine and log splitter.

To prevent rusting, coat the areas where paint has been scraped with an oil based rust inhibitor. Do not use heavy oil or grease because this will cause premature wear. Wipe off rust inhibitor before use.

Store the log splitter with the ram in fully retracted position.

It is required that you drain all of the gasoline from the gasoline tank and run the log splitter until all of the carburetor gasoline is exhausted before storing the log splitter.

MAINTENANCE RECORD

DATE	WORK PERFORMED	DATE	WORK PERFORMED

TROUBLESHOOTING POINTS

PROBLEM	CAUSE	CORRECTION
Will not start	<ol style="list-style-type: none"> 1. Out of fuel. 2. Engine not "CHOKED" properly. 3. Engine flooded. 4. Dirty air cleaner. 5. Water in fuel. 6. Clogged fuel tank. 7. Loose spark plug wire. 8. Bad spark plug or improper gap. 9. Carburetor out of adjustment. 	<ol style="list-style-type: none"> 1. Fill fuel tank. 2. See "TO START ENGINE" in Operation section. 3. Wait several minutes before attempting to start. 4. Clean or replace air cleaner cartridge. 5. Empty fuel tank and carburetor, and refill tank with fresh gasoline. 6. Remove fuel tank and clean. 7. Make sure spark plug wire is sealed properly on plug. 8. Replace spark plug or adjust gap. 9. Make necessary adjustments.
Hard to start	<ol style="list-style-type: none"> 1. Throttle control not set properly. 2. Dirty air cleaner. 3. Bad spark plug or improper gap. 4. Stale or dirty fuel. 5. Loose spark plug wire. 6. Carburetor out of adjustment. 7. Hydraulic oil too stiff (cold) 	<ol style="list-style-type: none"> 1. Place throttle control in "FAST" position. 2. Clean or replace air cleaner cartridge. 3. Replace spark plug or adjust gap. 4. Empty fuel tank and refill tank with fresh, clean gasoline. 5. Make sure spark plug wire is seated properly on plug. 6. Make necessary adjustments. 7. Use lighter weight oil (AW32/10W)
Loss of power	<ol style="list-style-type: none"> 1. Engine is overloaded. 2. Dirty air cleaner. 3. Low oil level/dirty oil. 4. Faulty spark plug. 5. Oil in fuel. 6. Stale or dirty fuel. 7. Water in fuel. 8. Clogged fuel tank. 9. Spark plug wire loose. 10. Dirty engine air screen. 11. Dirty/clogged muffler. 12. Carburetor out of adjustment. 13. Poor compression. 14. Clogged oil filter. 15. Hydraulic oil lever too low 	<ol style="list-style-type: none"> 1. Set depth stake for shallower tilling. 2. Clean or replace air cleaner cartridge. 3. Check oil level/change oil. 4. Clean and regap or change spark plug. 5. Empty and clean fuel tank and refill, and clean carburetor. 6. Empty fuel tank and refill fuel tank with fresh gasoline. 7. Empty fuel tank and carburetor, and refill tank with fresh gasoline. 8. Remove fuel tank and clean. 9. Connect and tighten spark plug wire. 10. Clean engine air screen. 11. Clean/replace muffler. 12. Make necessary adjustments. 13. Contact an authorized service center department. 14. Replace oil filter. 15. Add oil, 1" -2" from top of tank
Engine overheats	<ol style="list-style-type: none"> 1. Low oil level/dirty oil. 2. Dirty engine air screen 3. Dirty engine. 4. Partially plugged muffler. 5. Improper carburetor adjustment. 	<ol style="list-style-type: none"> 1. Check oil level/change oil. 2. Clean engine air screen. 3. Clean cylinder fins, air screen, and muffler area. 4. Remove and clean muffler. 5. Adjust carburetor to richer position.
Hydraulic components overheat	<ol style="list-style-type: none"> 1. Engine running too fast (rpm's too high) 	<ol style="list-style-type: none"> 1. Set engine rpm's at 3200.
Engine runs but labors when splitting	<ol style="list-style-type: none"> 1. Improper log position. 2. Throttle control not properly adjusted. 3. Carburetor out of adjustment. 	<ol style="list-style-type: none"> 1. Position log off center of wedge. 2. Check throttle control setting. 3. Make necessary adjustments.

PARTS BREAKDOWN

KP2042	Valve Stem
KP2052	Lug Nuts
KP2161	Label, Danger
KP7002	Wedge
KP7007	QS Hitch
KP7008	QS Main Beam
KP7010	Fenders, Pro
KP7011	Cylinder, 5 x 24" (29T)
KP7012	2- Stage Pump 16 G.P.M
KP7013	Valve
KP7016	Safety Chains
KP7017	Axle, #8 Torflex
KP7019	Filter Element
KP7021	Tire
KP7022	Rim 4 x 12
KP7023	Hitch Coupler
KP7026	Wedge Plate Spacer
KP7027	Wedge Plate Holder
KP7028	Jack Stand
KP7031	Suction Hose
KP7039	Bolt, Carr. 1/2 x 2 1/4
KP7041	Clevis Pin 1 1/4 x 3 1/2
KP7048	Fitting 6801-NW0-8-8
KP7052	Log Tray
KP7067	Jack Latch Pin
KP7069	Jack Pivot Spacer
KP7075	Cylinder, 4.5 x 24" (24T)
KP7077	Beam Latch Pin
KP7080	QS, Dislodger
KP7086	Engine Guard
KP7088	R. Valve Bracket
KP7089	Hose, 3/4 x 17
KP7090	Hose, 3/4 x 31
KP7091	Hose, 1/2 x 50 1/2
KP7092	Hose, 1/2 x 26
KP7095	Fitting 2501-12-12
KP7098	Fitting 45 6802-N-WO-8-8
KP7099	Fitting, 90 2501-8-8
KP7100	Grip, 1"
KP7119	Jack Latch Pin Assembly (pin, washer, spring, cotterpin)

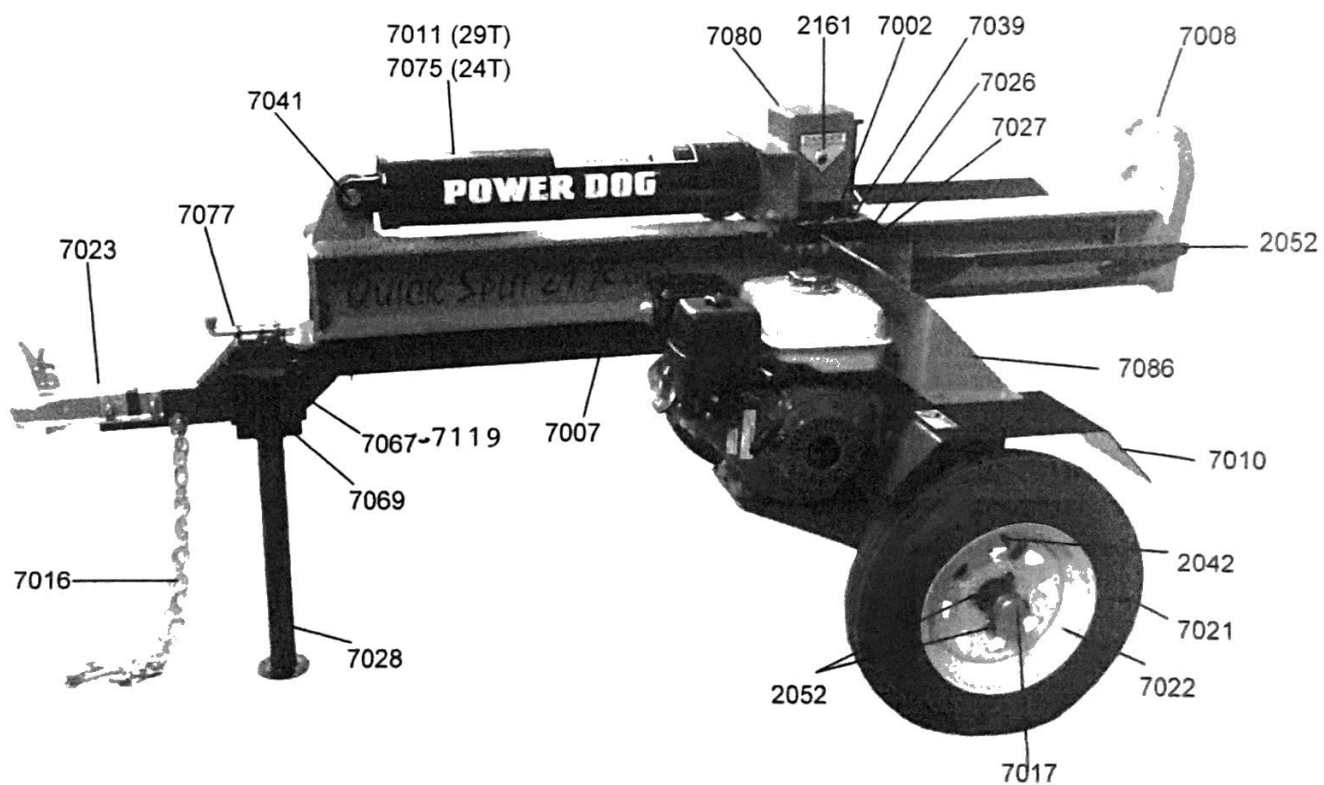
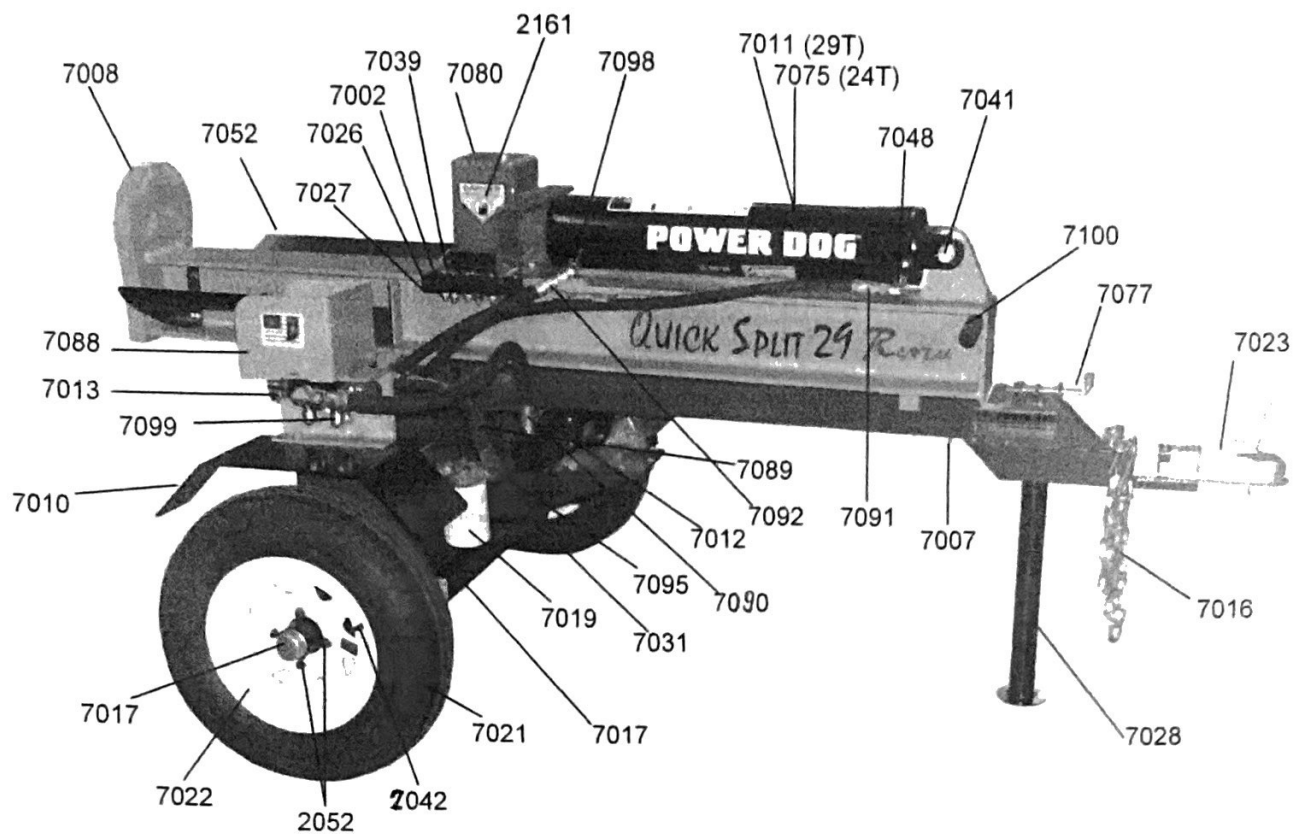

PARTS BREAKDOWN

KP7007	QS Hitch
KP7008	Main Beam
KP7009	QS Tank, Pro
KP7010	Fenders
KP7011	Cylinder 5 x 24" (29T)
KP7012	Pump, 2 Stage 16 gpm
KP7013	Valve
KP7016	Safety Chains
KP7018	Filter Head
KP7019	Filter
KP7021	Tire 6.30 x 12
KP7023	Hitch Coupler
KP7028	Jack Stand
KP7031	Hose, Suction
KP7035	Rubber Bumper
KP7039	Bolt, Carr. 1/2 x 2 1/4
KP7048	Fitting, 6801-NW0-8-8
KP7052	Log Tray
KP7055	Pump Mount 6hp
KP7056	Pump Mount 9hp
KP7075	Cylinder 4.5" x 24" (24T)
KP7077	Beam Latch Pin
KP7086	Engine Guard
KP7088	R. Valve Bracket
KP7089	Hose, 3/4 x 17
KP7090	Hose, 3/4 x 31
KP7091	Hose, 1/2 x 50 1/2
KP7092	Hose, 1/2 x 26
KP7095	Fitting, 2501-12-12
KP7096	Fitting, Straight, 2404-12-12
KP7097	Fitting, 90" Elbow, 6500-12-12
KP7098	Fitting, 45 degree, 6802-NWO-8-8
KP7100	Grip, 1"

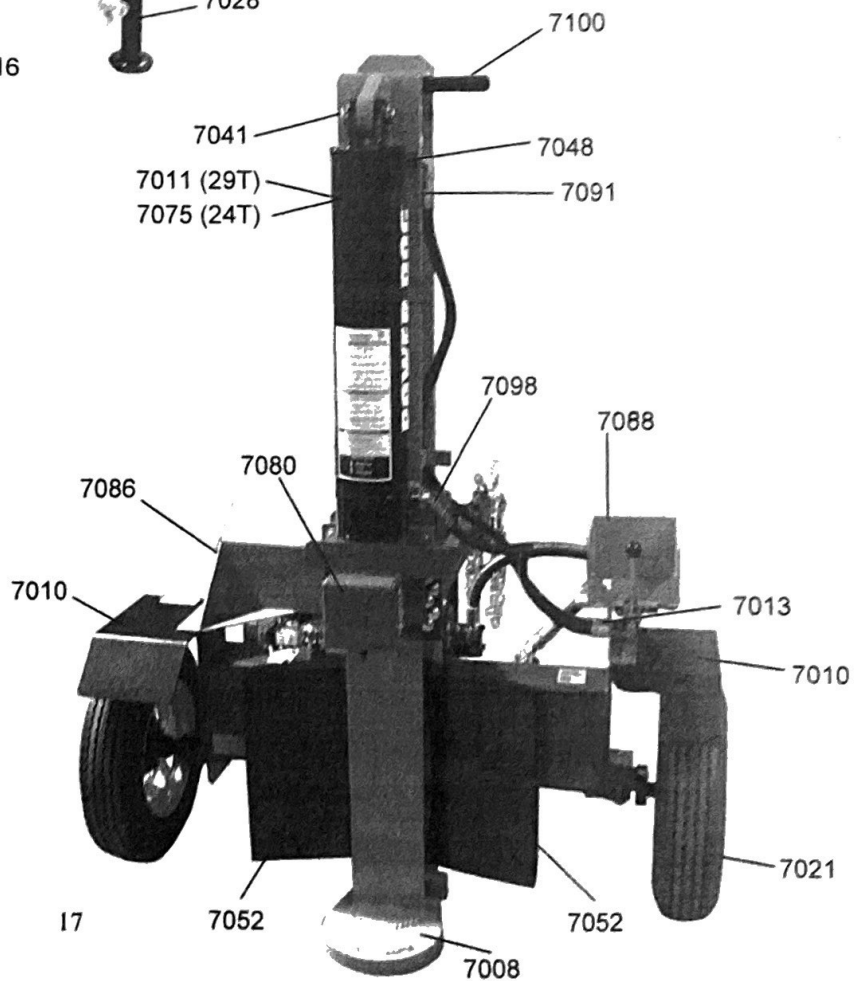
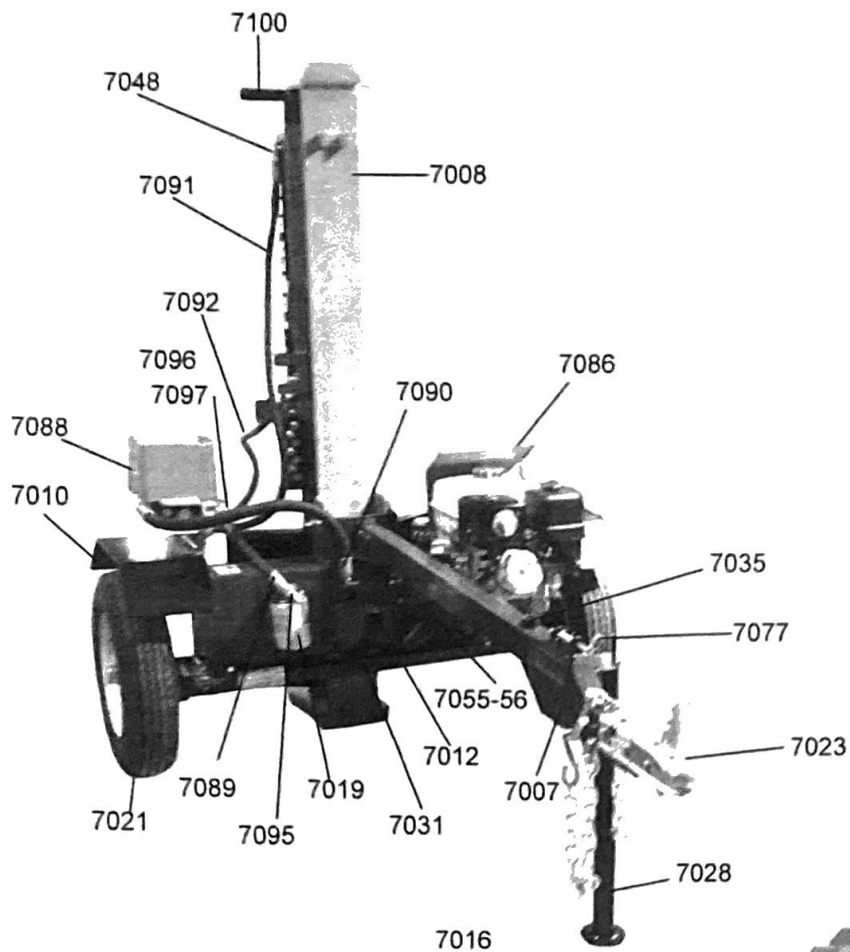

Power Dog™ WARRANTY STATEMENT

SECTION 1: LIMITED WARRANTY

Kuhn's Power Equipment, LLC, warrants Power Dog product to the original purchaser to be free from defects in material and workmanship from the date of purchase for the "Warranty Period" of the product as set forth below:

Batteries: 1 year prorated limited warranty with 100% replacement during the first 6 months.

Power Dog Safety Apparel carries a 6 month warranty from the date of the customer's original purchase for defects in material and workmanship. Normal wear, tear or abuse is not covered under warranty. Product must be returned to Nappa-nee with a warranty claim form. All care and maintenance instructions must be followed as stated by the manufacturer on the care label.

SECTION 2: KUHN'S POWER EQUIPMENT LLC OBLIGATIONS UNDER THE WARRANTY

Kuhn's Power Equipment will repair or replace defective components without charge for parts or labor if a component fails because of a defect in material or workmanship during the warranty period.

SECTION 3: ITEMS NOT COVERED BY THIS WARRANTY

The following items are not covered by this warranty:

- (1) Normal customer maintenance items which become worn through normal regular use, including, but not limited to, belts, blades, blade adapters, bulbs, clutches, clutch drums, filters, guide bars, lubricants, rewind springs, spark plugs, starter ropes and tines;
- (2) Natural discoloration of material due to ultraviolet light;
- (3) Engine and drive systems not manufactured by Kuhns Power Equipment LLC; these items are covered by the respective manufacturer's warranty as provided in writing with the product information supplied at the time of purchase; all claims must be sent to the appropriate manufacturer;
- (4) Lawn and garden attachments are covered by a third party which gives a warranty, all claims for warranty should be sent to the manufacturer;
- (5) Emission Control System components necessary to comply with CARB-TIER II and EPA regulations which are manufactured by third party engine manufacturer.

SECTION 4: EXCEPTIONS AND LIMITATIONS

This warranty shall be inapplicable to defects resulting from the following:

- (1) Accident, abuse, misuse, negligence and neglect, including stale fuel, dirt, abrasives, moisture, rust, corrosion, or any adverse reaction due to incorrect storage or use habits;
- (2) Failure to operate or maintain the unit in accordance with the Owner's/Operator's manual or instruction sheet furnished by Kuhns Power Equipment LLC;

- (3) Alterations or modifications that change the intended use of the product or affects the product's performance, operation, safety, or durability, or causes the product to fail to comply with any applicable laws; or
- (4) Additional damage to parts or components due to continued use occurring after any of the above.

REPAIR OR REPLACEMENT AS PROVIDED UNDER THIS WARRANTY IS THE EXCLUSIVE REMEDY OF THE PURCHASER. KUHN'S POWER EQUIPMENT LLC SHALL NOT BE LIABLE FOR ANY INCIDENTAL OR CONSEQUENTIAL DAMAGES FOR BREACH OF ANY EXPRESS OR IMPLIED WARRANTY ON THESE PRODUCTS EXCEPT TO THE EXTENT PROHIBITED BY APPLICABLE LAW. ANY IMPLIED WARRANTY OF MERCHANTABILITY OR FITNESS FOR A PARTICULAR PURPOSE ON THESE PRODUCTS IS LIMITED IN DURATION TO THE WARRANTY PERIOD AS DEFINED IN THE LIMITED WARRANTY STATEMENT. KUHN'S POWER EQUIPMENT LLC RESERVES THE RIGHT TO CHANGE OR IMPROVE THE DESIGN OF THE PRODUCT WITHOUT NOTICE, AND DOES NOT ASSUME OBLIGATION TO UPDATE PREVIOUSLY MANUFACTURED PRODUCTS.

Some states do not allow the exclusion of incidental or consequential damages, or limitations on how long an implied warranty lasts, so the above limitations or exclusions may not apply to you. This warranty gives you specific legal rights, and you may also have other rights which vary from state to state.

SECTION 5: CUSTOMER RESPONSIBILITIES

The product must exhibit reasonable care, maintenance, operation, storage and general upkeep as written in the maintenance section of the Owner's/Operator's manual. Should an operational problem or failure occur, the product should not be used, but delivered as is to an authorized Power Dog retailer for evaluation. Proof of purchase, as explained in section 6, rests solely with the customer.

SECTION 6: PROCEDURE TO OBTAIN WARRANTY CONSIDERATION

It is the Owner's and Retailer's responsibility to make certain that the Warranty Registration Card is properly filled out and mailed to Kuhns Power Equipment LLC. This card should be mailed within ten (10) days from the date of purchase in order to confirm the warranty and to facilitate post-sales service.

Proof of purchase must be presented to the authorized Power Dog retailer in order to obtain warranty service. This proof must include date purchased, model number, serial number, and complete name and address of the selling retailer.

To obtain the benefit of this warranty, the product believed to be defective must be delivered to an authorized Power Dog retailer in a timely manner, no later than thirty (30) days from date of the operational problem or failure. The product must be delivered at the owner's expense. Downtime, pick-up and delivery charges are not covered by this warranty.